

304SS CANISTER ACTUATOR K1111 SERIES

Features & Specifications

- » Constructed of 304 stainless steel
- » Available as Air/Spring or Air/Air operated
- » Solenoid and proximity switches are available
- » K1111-1 (non-solenoid) equipped with friction fit plastic top
- » K1111-2 has secured NEMA 4 stainless cover with solenoid and mechanical limit switch
- » K1111-3 NAMUR solenoid and magnetic proximity switch
- » Designed specifically to actuate up to 3" butterfly valves
- » Protected NEMA 4 dome ideal for locations requiring washdown without damaging sensitive electronics
- » Suitable for pharmaceutical and food processing application
- » Actuator available sizes from ½" to 4"

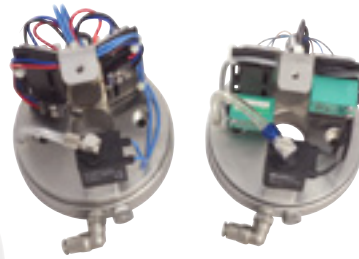

| Item | Part (Qty) | Material |
|------|---------------------------------|----------|
| 1 | Body | 304 SS |
| 2 | Coupling Axle Piece | 304 SS |
| 3 | Mounting Bracket | 304 SS |
| 4 | Plastic Positioning Ring | 304 SS |
| 5 | M6x30 Stainless Steel Screw (2) | 304 SS |
| 6 | M6 Nut (2) | 304 SS |
| 7 | M8x12 Stainless Steel Screw (2) | 304 SS |
| 8 | Air Outlet Filter | Teflon® |
| 9 | Piston O-ring | Teflon® |
| 10 | Air Connection | Copper |
| 11 | Connection | 304 SS |
| 12 | Cover | 304 SS |
| 13 | Inox Piston Stem | 304 SS |
| 14 | Stem Protection Plug | 304 SS |
| 15 | Air Flow Tube Guide | 304 SS |
| 16 | Micro Switch | 304 SS |
| 17 | Proximity Detector | 304 SS |
| 18 | Solenoid | 304 SS |

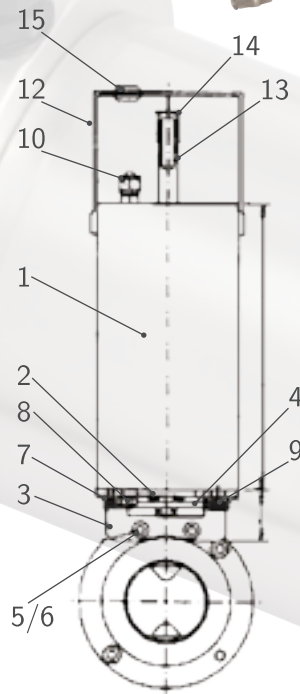

K1111-1

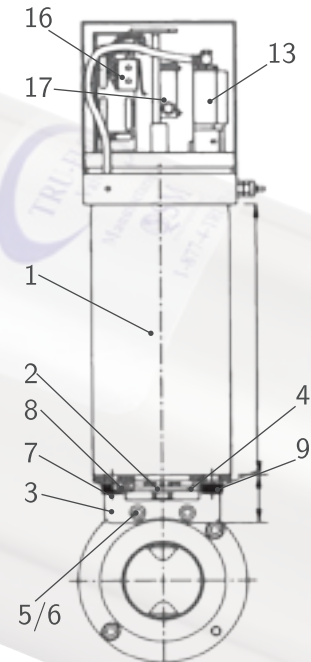

K1111-2
Solenoid & Mechanical
Limit Switch

K1111-3
Solenoid & Magnetic Proximity Switch