



Series 50

Technical Drawing No. FLC 50-100

Date: September, 2006/ Page 1 of 1

Valve Design: Pilot operated hi-flow spool
Port Connections: 1/8", 1/4", 1/2" NPT
Media: Lubricated or non-lubricated air
Mounting: NAMUR (VDI / VDE 3845)
Pressure Range: 30 to 150 psi
Flow Factor: Cv – 0.78, Cv – 0.89, Cv – 1.40, Cv – 1.68, Cv – 2.79
Materials of Construction:
 Body: Extruded Aluminum, Hard Anodized, Polyester Coated
 Spool: ENP Aluminum
 Piston: Aluminum
 Spring: Stainless Steel
 Seals: Buna N
 Screws: Stainless Steel
 Core/Tube: Stainless Steel / Brass

Power Consumption: AC – 4.5 VA DC – 3W
Duty Cycle: Continuous (100%)
Shortest Excitation Time: 0.05 sec
Coil Voltages: DC – 12V, 24V, 110V.AC – 24V, 36V, 110V, 220V, 380V, 50/60Hz
Protection Class: NEMA 4, 4x, NEMA 7 & 9
Coil Insulation: Class F standard Class H optional
Operating Speed: 25 cycles per minute
Ambient Temperature Range:
Coil Connections: Cable Gland
 1/2" Conduit / Potted Leads, Din Connector with Potted Leads

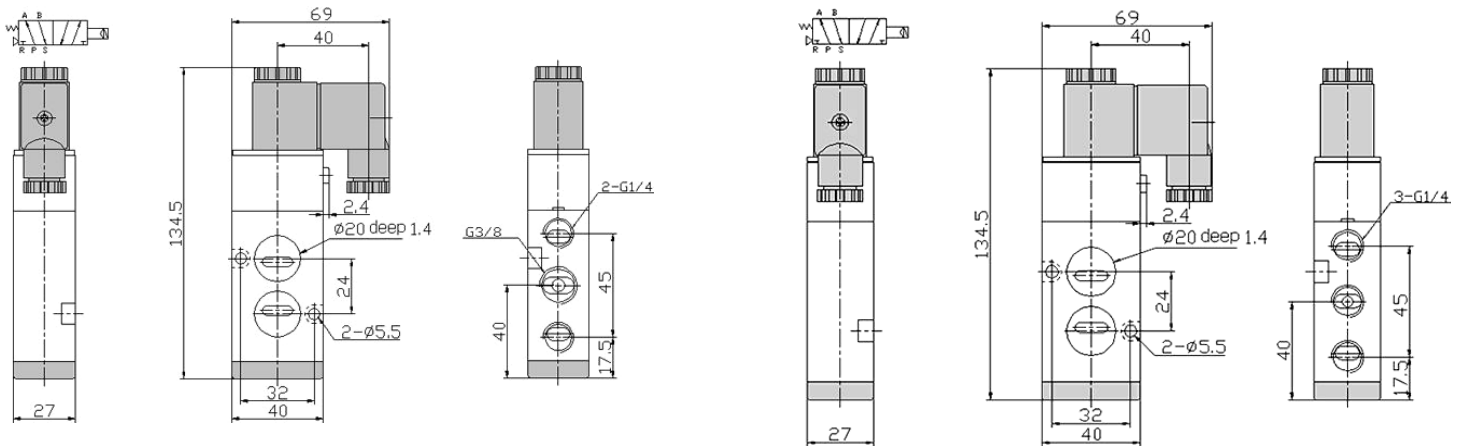
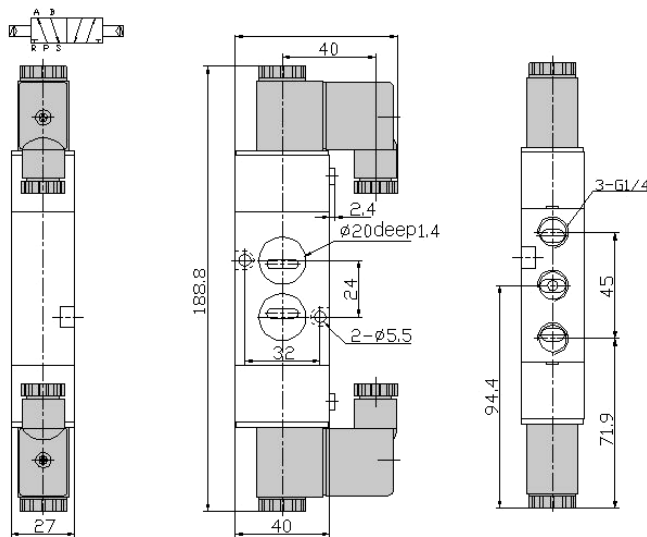

Dimensions in mm